

09/2016



water passion

# CT 61

Peripheral Pump



### Construction

Close-coupled peripheral pump (regenerative pump) with turbine impeller. Compact, patented construction with single-piece motor casing and pump-side wall. Protected against water entering the motor from outside.

CT: version with pump casing in cast iron.  
B-CT: version with pump casing in bronze  
(the pumps are supplied fully painted).

### Applications

For clean liquids without abrasives, without suspended solids, non-explosive, non-aggressive for the pump materials. For increasing network pressure (follow local specifications). For the reduced dimensions, these pumps are very well suitable to be mounted in cooling and air-conditioning machines and equipments, circulation.

### Operating conditions

Liquid temperature up to 60 °C.  
Ambient temperature up to 40 °C.  
Total suction lift up to 7 m.  
Continuous duty.

### Motor

2-pole induction motor, 50 Hz ( $n \approx 2900$  rpm).  
**CT 61:** three-phase 230/400 V  $\pm 10\%$ .  
**CTM 61:** single-phase 230 V  $\pm 10\%$ , with thermal protector. Capacitor inside the terminal box.

Insulation class F.  
Protection IP 54.  
Constructed in accordance with: EN 60034-1;  
EN 60335-1, EN 60335-2-41.

### Special features on request

- Other voltages.
- Frequency 60 Hz (as per 60 Hz data sheet).
- Special mechanical seal.

### Materials

Components	CT 61	B-CT 61
Pump casing	Cast iron GJL 200 EN 1561	Bronze G-Cu Sn 10 EN 1982
Casing cover motor side	Brass P- Cu Zn Pb 2 UNI 5705	
Impeller	Brass P- Cu Zn Pb 2 UNI 5705	
Shaft	Chrome steel 1.4104 EN 10088 (AISI 430)	
Mechanical seal	Carbon - Ceramic - NBR	

### Coverage chart $n \approx 2900$ rpm

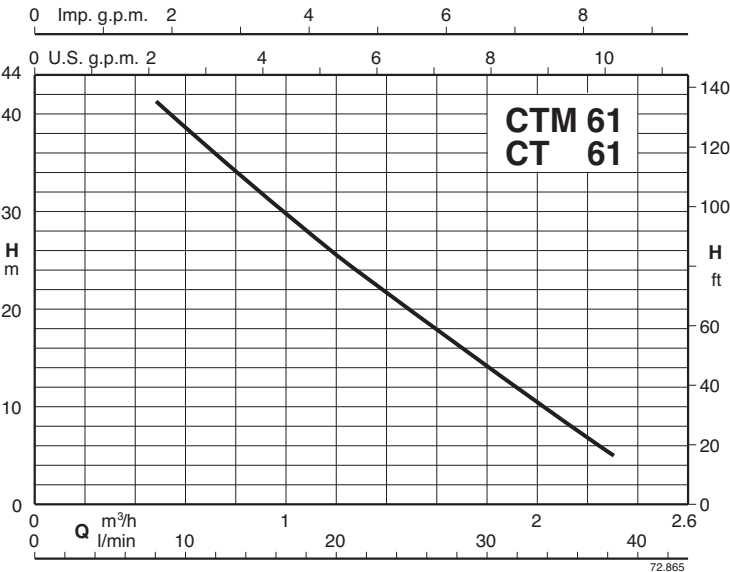

Performance n ≈ 2900 rpm

3~	230V 400V		1~	230V	P <sub>2</sub>		Q	0,48	0,6	0,75	0,96	1,2	1,5	1,89	2,3
	A	A		A	kW	HP									
CT 61 B-CT 61	1,9	1,1	CTM 61 B-CTM 61	2,5	0,33	0,45	H m	41	38,5	35,5	31	25,5	19	11	3

H Total head in m. P<sub>2</sub> Rated motor power output.

Dimensions and weights

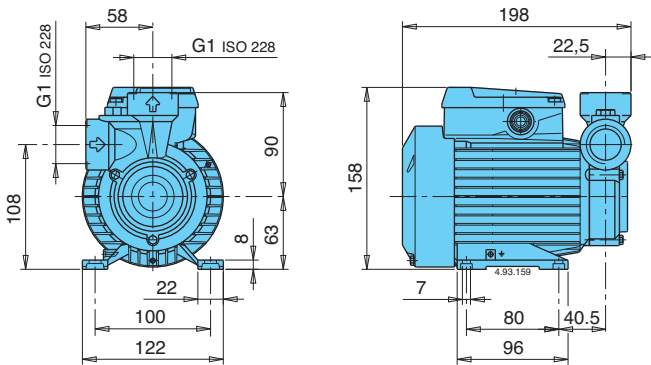

CT 61	4,9	kg
CTM 61	5	kg
B-CT 61	5,1	kg
B-CTM 61	5,2	kg

Features

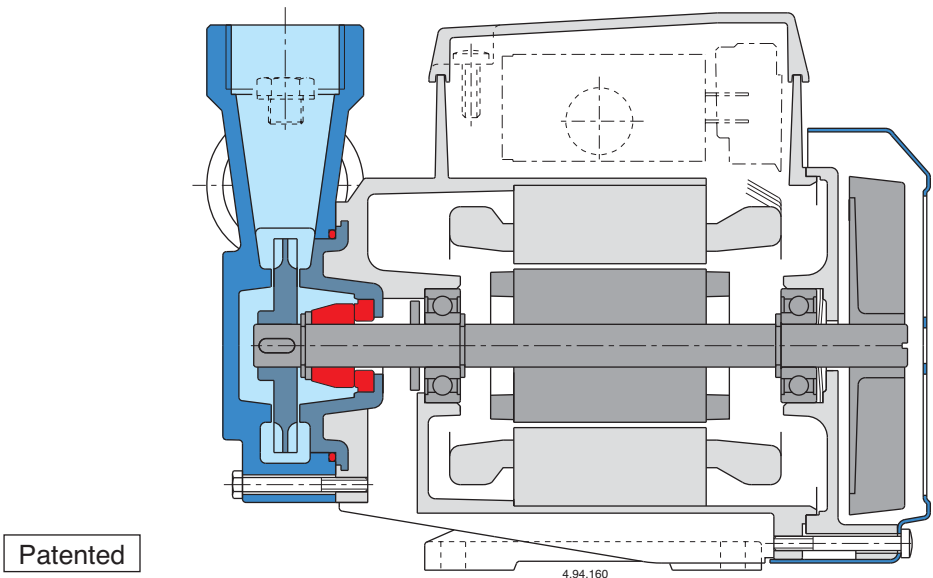

# CT 60

Peripheral Pump



## Materials

Components	Materials
Pump casing	Cast iron GJL 200 EN 1561
Casing cover motor side	Brass P- Cu Zn Pb 2 UNI 5705
Impeller	Brass P- Cu Zn Pb 2 UNI 5705
Shaft	Chrome steel 1.4104 EN 10088 (AISI 430)
Mechanical seal	Carbon - Ceramic - NBR

## Construction

Close-coupled peripheral pump (regenerative pump) with turbine impeller.  
Compact, patented construction with single-piece motor casing and pump-side wall.  
Protected against water entering the motor from outside.

## Applications

For clean liquids without abrasives, without suspended solids, non-explosive, non-aggressive for the pump materials.  
For increasing network pressure (follow local specifications).  
For the reduced dimensions, these pumps are very well suitable to be mounted in cooling and air-conditioning machines and equipments, circulation.

## Operating conditions

Liquid temperature up to 60 °C.  
Ambient temperature up to 40 °C.  
Total suction lift up to 7 m.  
Continuous duty.

## Motor

2-pole induction motor, 50 Hz ( $n \approx 2900$  rpm).

**CT 60:** three-phase 230/400 V  $\pm 10\%$ .

**CTM 60:** single-phase 230 V  $\pm 10\%$ , with thermal protector.  
Capacitor inside the terminal box.

Insulation class F.

Protection IP 54.

Constructed in accordance with: EN 60034-1;  
EN 60335-1, EN 60335-2-41.

## Special features on request

- Other voltages.
- Frequency 60 Hz (as per 60 Hz data sheet).
- Special mechanical seal.

## Coverage chart $n \approx 2900$ rpm

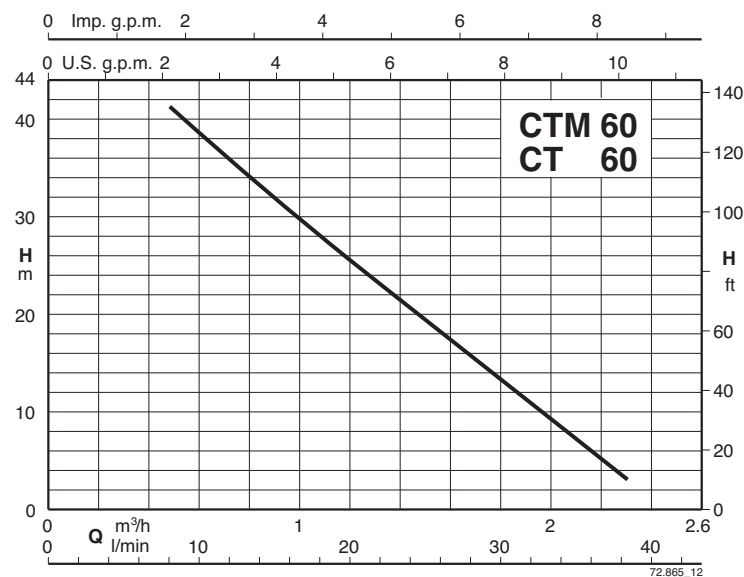

# CT 60

## Peripheral Pump



### Performance $n \approx 2900$ rpm

3~	230V A	400V A	1~	230V A	P <sub>2</sub>		Q m³/h l/min	0,48	0,6	0,75	0,96	1,2	1,5	1,89	2,3
								8	10	12,5	16	20	25	31,5	38
CT 60	1,9	1,1	CTM 60	2,5	0,33	0,45	H m	41	38,5	35,5	31	25,5	19	11	3

H Total head in m.                      P<sub>2</sub> Rated motor power output.

### Dimensions and weights

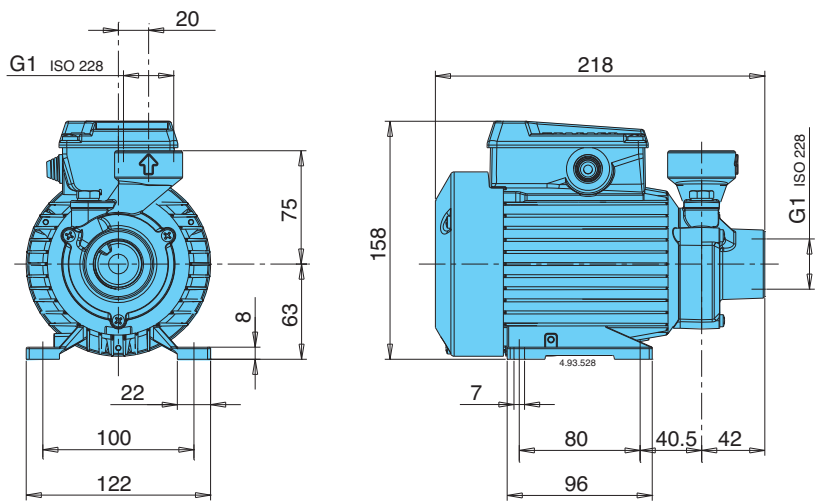

CT 60 4,9 kg  
CTM 60 5 kg

### Features

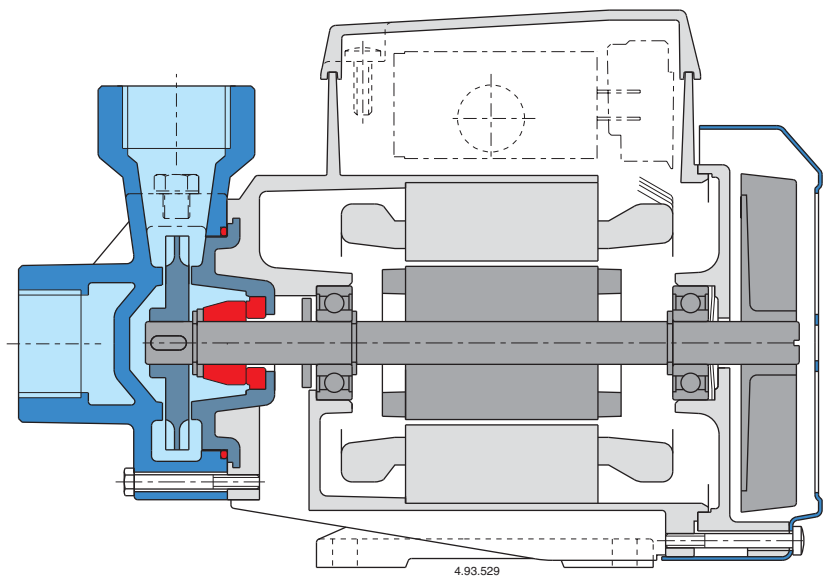

Patented